

The Estate Agent People Recommend



14 Verey Close,
Twyford
RG10 0LW

£260,000



Wentworth Estate Agents have the pleasure to offer a SPACIOUS ONE BEDROOM back to back property located on the popular Broad Hinton development.

Ground floor accommodation comprises of living room, kitchen with plenty of eye and base level units, fridge/freezer, oven, hob and space for washing machine. From the kitchen access to the conservatory with direct access to a private laid to lawn garden.

First floor accommodation comprises of a double bedroom with storage space and a family bathroom with WC, wash hand basin and bath with shower over.

Further benefits include two private off road parking spaces, next to the park area and a short distance to Twyford Village Centre, local shops and Twyford mainline station serving London Paddington and Reading

EPC Rating - E

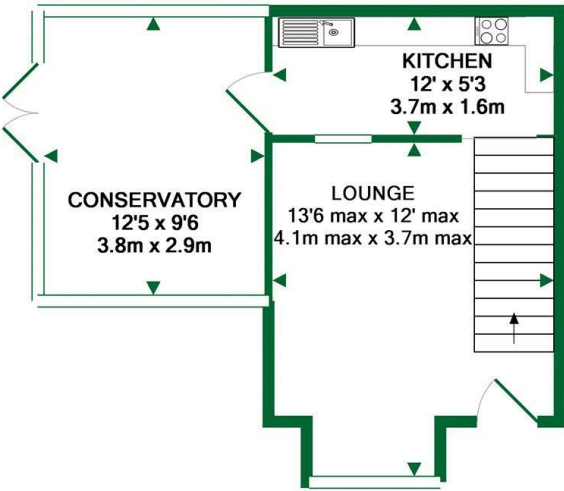

GROUND FLOOR
APPROX. FLOOR
AREA 331 SQ.FT.
(30.8 SQ.M.)

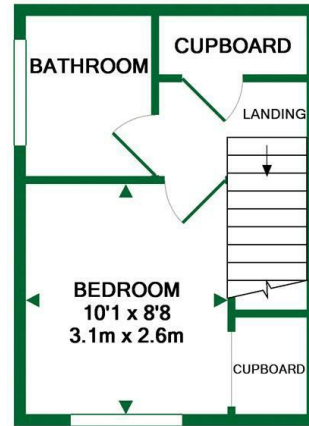

1ST FLOOR
APPROX. FLOOR
AREA 204 SQ.FT.
(19.0 SQ.M.)

TOTAL APPROX. FLOOR AREA 536 SQ.FT. (49.8 SQ.M.)

Whilst every attempt has been made to ensure the accuracy of the floor plan contained here, measurements of doors, windows, rooms and any other items are approximate and no responsibility is taken for any error, omission, or mis-statement. This plan is for illustrative purposes only and should be used as such by any prospective purchaser. The services, systems and appliances shown have not been tested and no guarantee as to their operability or efficiency can be given
Made with Metropix ©2018



ACCOMMODATION

- ONE DOUBLE BEDROOM HOUSE
- WITHIN WALKING DISTANCE TO TWYFORD STATION
- GOOD SIZE CONSERVATORY
- MODERN KITCHEN
- QUIET CUL DE SAC
- PRIVATE LAID TO LAWN GARDEN
- NEXT TO THE PARK AREA
- TWO OFF ROAD PARKING SPACES



wentworthea.com

The Old Butchers, 15 High Street, Twyford, Berkshire, RG10 9AB
t: 0118 934 0027 e: twyford@wentworthea.com



wentworth_ea



wentworthestateagents

IMPORTANT: we would like to inform prospective purchasers that these sales particulars have been prepared as a general guide only. A detailed survey has not been carried out, nor the services, appliances and fittings tested. Room sizes should not be relied upon for furnishing purposes and are approximate. If floor plans are included, they are for guidance only and illustration purposes only and may not be to scale. If there are any important matters likely to affect your decision to buy, please contact us before viewing the property.